

High Current Socket Pin, thread type

- Screwing it into panels, or fixing to panels with nut.
- We welcome your custom design products.
- Larger plug dia. sockets are also available, please call us.
- Gold plating over Ni (Standard Product)

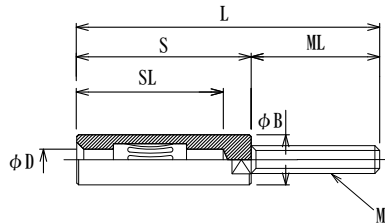

Part Number	Plug dia.	φB	φD	L	M	ML	S	SL	Current rating (A)	
UJMST20AG	2.0	5.5	2.2	33.0	M3x0.5P	coarse thread	14.0	19.0	15.5	20
UJMST20AG-L360	2.0	5.5	2.2	36.0	M3x0.5P		16.0	20.0	15.5	20
UJMST30AG	3.0	6.0	4.1	39.0	M4x0.7P		19.0	20.0	16.5	38
UJMST40AG	4.0	8.0	5.2	49.0	M5x0.8P		24.0	25.0	20.0	60
UJMST40AG-L500	4.0	7.0	5.2	50.0	M5x0.8P		25.0	25.0	19.8	60
UJMST50AG	5.0	8.3	5.9	50.0	M5x0.8P		25.0	25.0	20.0	66
UJMST60AG	6.0	9.6	6.8	52.0	M6x1.0P	fine thread	27.0	25.0	23.0	83
UJMST80AG	8.0	14.0	8.0	61.0	M8x1.0P		36.0	25.0	23.0	105

Full thread Socket Pins

- Fixing to panels with nut.
- Both side insertable.
- Gold plating over Ni (Standard Product)

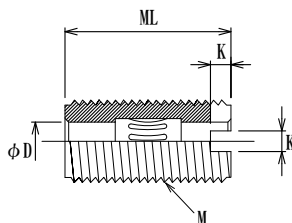

Part Number	Plug dia.	φD	M	ML	K	Current rating (A)
UJMSW40AG	4.0	4.3	fine thread	20.0	2.5	50
UJMSW50AG	5.0	5.2		24.0		66
UJMSW80AG *	8.0	8.2		M14X1.5P		105

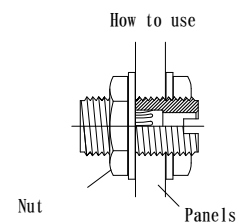

* mark product is made only upon order.